

IG-168-136R-NR



InGround LED Spot



Inground LED spot

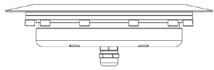

- ✔ 36W Max
- ✔ IP68 for wet locations
- ✔ 50,000 hour lifetime
- ✔ CNC Stainless steel housing
- ✔ 500Kg walkover
- ✔ Installation accessories supplied

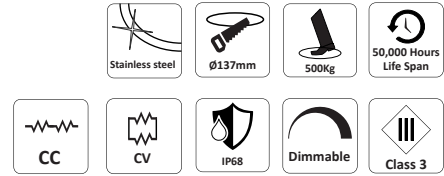

SPECIFICATIONS

Power	LED 12 X 3W 700 mA
Light Color	White: Warm, Neutral, Cool Color: Red, Green, Blue, Amber, RGB
White light CCT	2700K 4,000K 6,000K
Lumen Output ¹	1920lm 2160lm 2280lm
White light CRI ²	≥80 - Standard ≥90
Beam	5°, 15°, 25°, 45°, Wide (frosted)
Optics	20mm Optics Clear or frosted cover

Diameter	ø96
Installation cut off	ø48mm (without concrete box)
Height	74mm (without cable)
Weight	310g

Housing	Stainless steel, tempered crystal glass cover
Housing color	Natural steel with passivation
IP Rating	Under water - IP68
Operating Temp.	-20°C to 40°C
Cable	100cm Neoprene cable - Standard
Connectors	Open Wires
Accessories	B-136 - Concrete box (ø160 mm x 83mm)

Extras

Cable	Custom cable length up to 50m
Power Supply	Constant Current
Control	On/Off 0-10V Triac DMX DALI

DRAWINGS

TOP

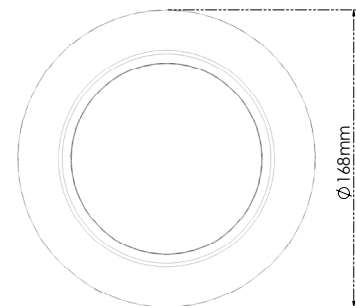

SIDE

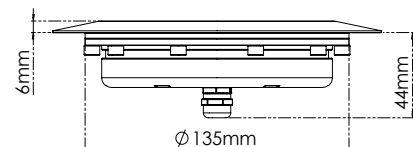

Notes:

- 1 LEDs have ±10% output tolerance in accordance to manufacturer specifications
- 2 CRI 90 version is available upon request only
- 3 Extras are not supplied by default and priced separately